

# Quick Guide

Installation for AC800/AC900 Series on **Wooden Door**



**FINGERTEC**  
One finger solves it all  
www.fingertec.net

STEP 1

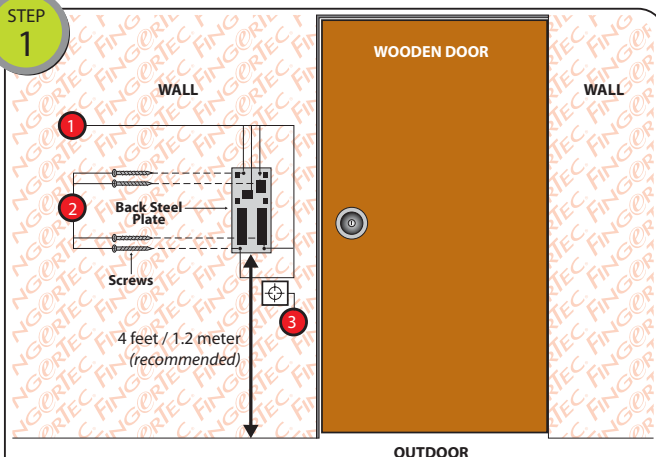

- 1 To install FingerTec® AC900/ AC800/AC800 Plus on the wall, drill 5 holes as shown. 4 small holes are for screws and the bigger hole is for the network cable.
- 2 Tighten the 4 screws to fix the **Back Plate** on the wall.
- 3 Install the keyswitch as per instructions given in the box. The keyswitch is an override key in case of system failure or breakdown.

STEP 2

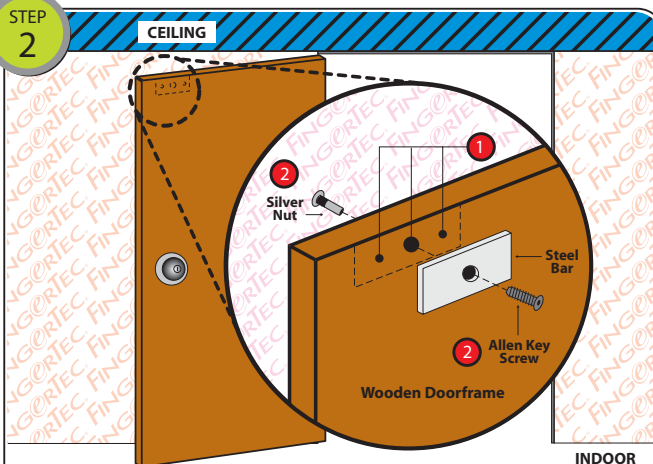

- 1 Drill 3 holes on the wooden door.
- 2 Place Steel Bar on the door. Insert the Silver Nut on one side and Allen Key Screw on the other side. Tighten the screw to lock the Steel Bar onto its position.

STEP 3

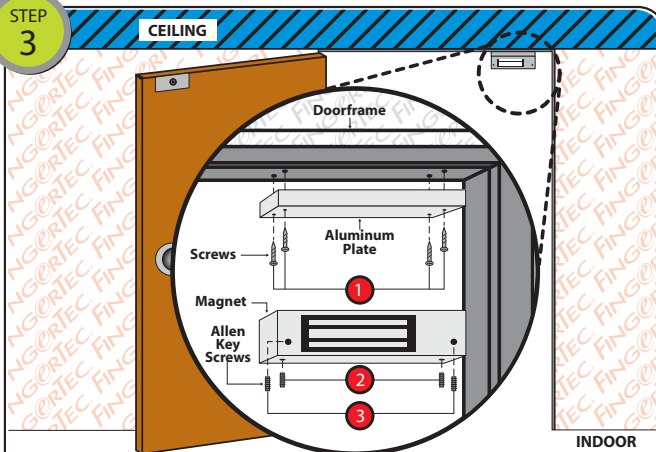

- 1 Drill 4 holes on the wooden frame. Tighten the 4 screws to fix the Aluminum Plate properly on the doorframe.
- 2 Use Allen Key to tighten the 2 screws at the bottom of the Magnet. The Magnet will stick to the Aluminum Plate when the screws are tightened up.
- 3 Use Allen Key to tighten the other 2 screws on the sides of the Magnet.

STEP 4

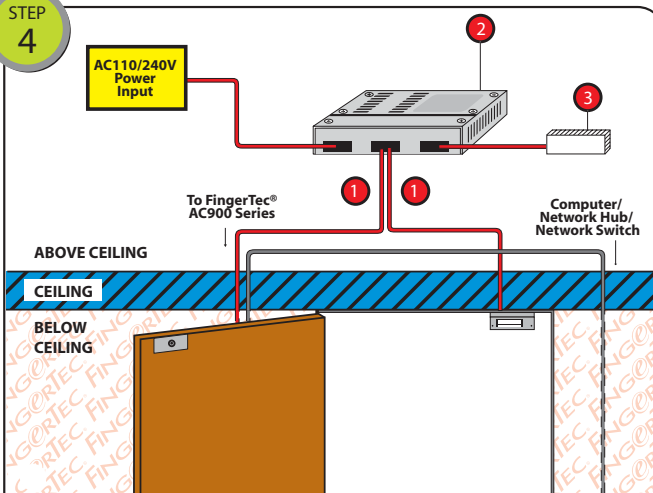

- 1 12V 3A DC Power Output
- 2 Adaptec AC (Note: Refer to page 5-11 for wiring diagrams.)
- 3 12V Rechargeable Battery

Note: It is recommended to place ①, ② and ③ out of sight, either above the ceiling or wall-mounted.

STEP 5

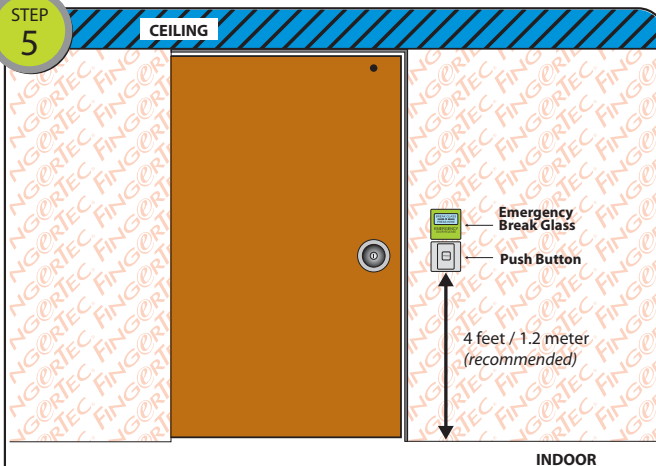

Emergency Break Glass and Push Button should be installed indoor. These two items are for user to open the door from the inside.

Note: Please conceal the wiring.

STEP 6

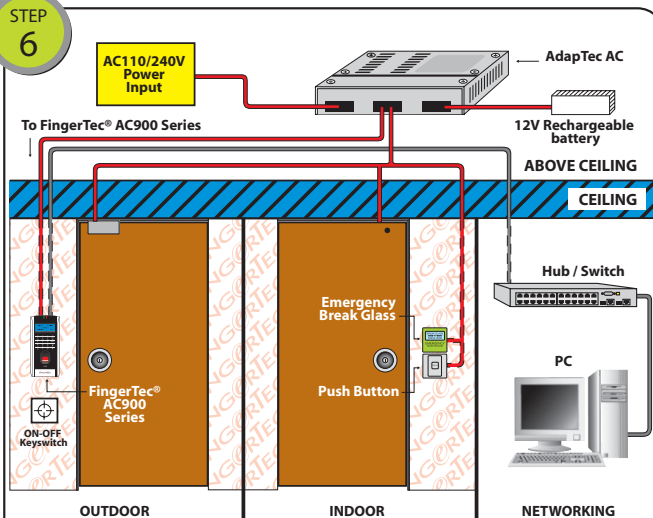

OVERVIEW OF THE WHOLE SYSTEM INSTALLATION