

**Adaptability towards
Enhanced Power Systems**



The new AdapTec TA comes with dual power output DC 5V and DC 12V. This accessory works as a power supply medium to provide power backup to FingerTec's terminals with time attendance function. In the event of power failure, a DC 12V rechargeable battery sustains AdapTec TA's power supply to ensure a longer standby time. Consisting of a power supply/power input as well as a power output module, AdapTec TA can also connect to other devices that utilize the similar power requirement of a DC 5V 2A. With a siren bell and relevant devices that facilitate the external siren feature, the new AdapTec TA supports DC 12V Siren and DC 12V rechargeable backup battery.



**Supports Rechargeable
Backup Battery**

The AdapTec TA can connect to any DC 12V rechargeable backup battery, providing a power supply to ensure the FingerTec terminals will still function in an event of power failure.



Supports DC 12V Siren

It can power up the siren (max DC 12V 1A) to alert employees on start/stop working time, shift change etc.



**Powers Up 2 Units of
FingerTec Terminals**

The AdapTec TA can simultaneously power up 2 units of DC5V 2A and DC12V FingerTec terminals. You no longer need to add power points or adapters for 2 units of FingerTec terminals.



**Cleaner Installation with DIY
Metal Casing**

Store the AdapTec TA and its backup battery in an exclusive FingerTec DIY metal casing, providing a neat installation.



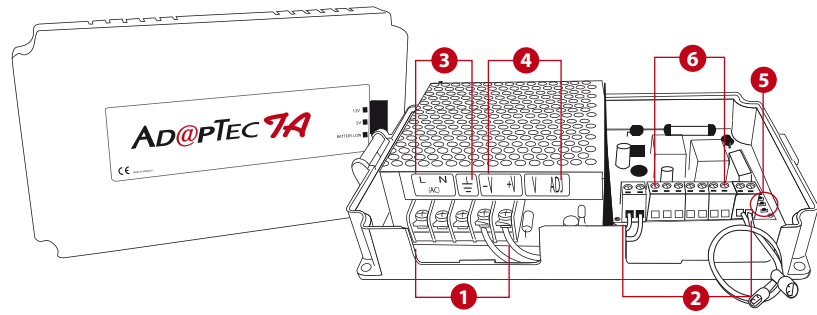

The AdapTec TA consists of 2 main modules:

- ❶ Power supply/power input module.
- ❷ Power output module.

POWER SUPPLY/POWER INPUT MODULE

- ❸ This portion is to be connected to a power source with AC110~240V. An AC current will be supplied into this side and a DC 12V 3A current will be generated as output.
- ❹ These two cables, -V and +V are defaults and connected to the inner part of AdapTec TA. Please do not remove or replace these cables.

POWER OUTPUT MODULE

- ❺ The LED lights up to indicate the following:
 - **5V LED** - The DC 5V output is working properly.
 - **12V LED** - The DC 12V output is working properly.
 - Note: Contact support@fingertec.com if none of the LED lights up.*
 - **Bat Low LED** - The battery is weak and needs to be charged or replaced.
- ❻ These are the power outputs from the AdapTec TA. FingerTec terminals and sirens will use these outputs. Please refer to the wiring diagram for more details.

Installation Diagram

for illustration only

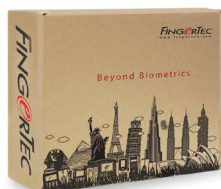
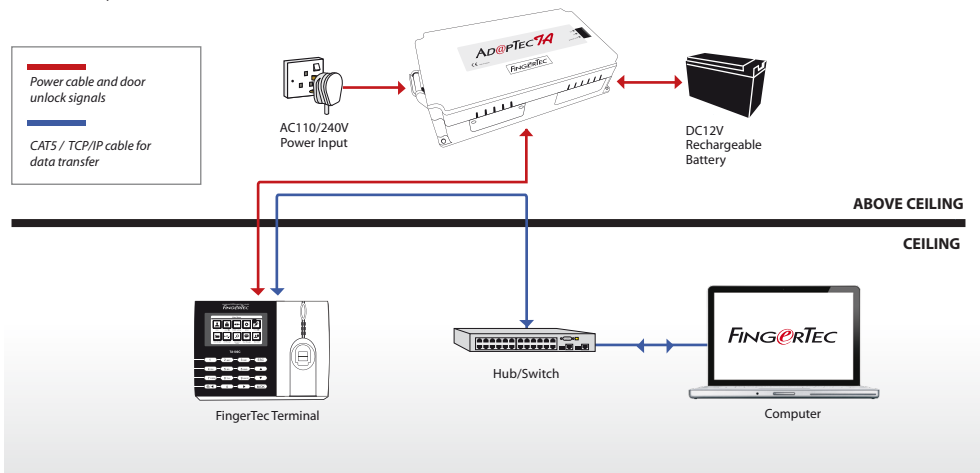

Packaging

Dimension (mm) : 225 (L) x 72 (W) x 168 (H)
Weight : 1.26kg

SPECIFICATIONS

Surface finishing	Zinc alloy
Dimension (mm)	198 x 131 x 43
Weight (g)	900
Input power	AC110 ~ 240V
Output power	DC 5V 2A, DC 12V 1A DC 12V 1A (Siren)
Backup power	UPS or DC 12V rechargeable battery

NOTE: Specifications are subject to change. Check <http://product.fingertec.com> for latest product information.

Authorized Reseller:



timeTec
www.timeteccloud.com
TimeTec © 2021, All Rights Reserved