

Confirmed. It's me.

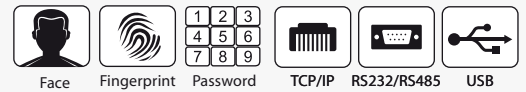

Face ID 2 FMM
2-in-1 Face & Fingerprint Recognition Terminal



Face ID 2 is a dual function biometric verification terminal that uses face and fingerprint technology in one single system. User only needs to look at the camera and get his verification done in split seconds. Fingerprint and password are the other credential options available in Face ID 2. If you require a contactless and effective biometrics solution, choose FingerTec Face ID 2!

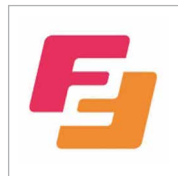

Contactless Identification
One of the many advantages of face identification is its contactless nature. Just stand still in front of the camera and get verified.

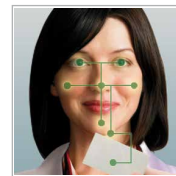

Multi-Verification Method
Face ID 2 offers different types of identity verifications: Fingerprint, Face ID and password.

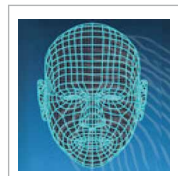

Double your Security
Face ID 2 caters to a tighter access control system with implementation of both face & fingerprint biometric authentication methods simultaneously.



Get Verified in a Flash
It takes 2 seconds to verify an identity through a face recognition and 1 second for fingerprint. It'll be done before you know it!



Security and Accuracy from a System
Face ID 2 can be installed for door access and staff time & attendance providing companies with security and data accuracy from one single system.



Supersized Capacity
Face ID 2 can store up to 1200 face templates, 10000 fingerprint templates and up to 200000 transaction logs which can be downloaded into a computer via TCP/IP, RS232, RS485, or via USB flash disk connection.



Shortcut Keys
Face ID 2 presents users with the convenient shortcut keys, programmable for the commonly used functions.



Touch Screen Menu
The full colour touch screen in Face ID 2 makes it easy for users to navigate through the system.

WEB LINK

Product
<https://product.fingertec.com>

- Quick Start Guide
- Installation Guide
- User Guide
- Video Guide
- Technical Tips

Ingress Software
<http://info.fingertec.com/ingress>

LAYOUT PLAN

System Communication

for illustration only

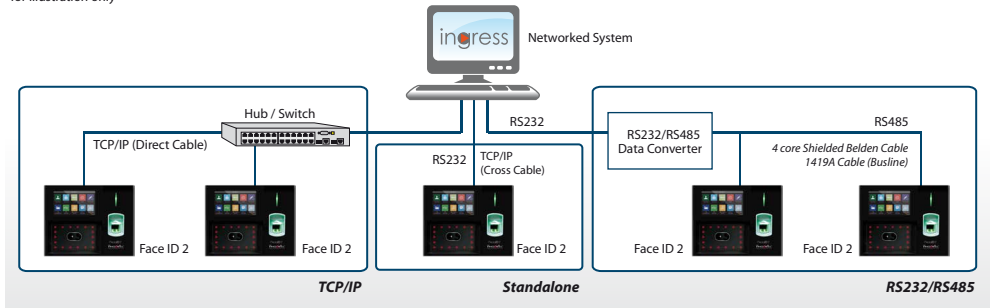

Installation Diagram

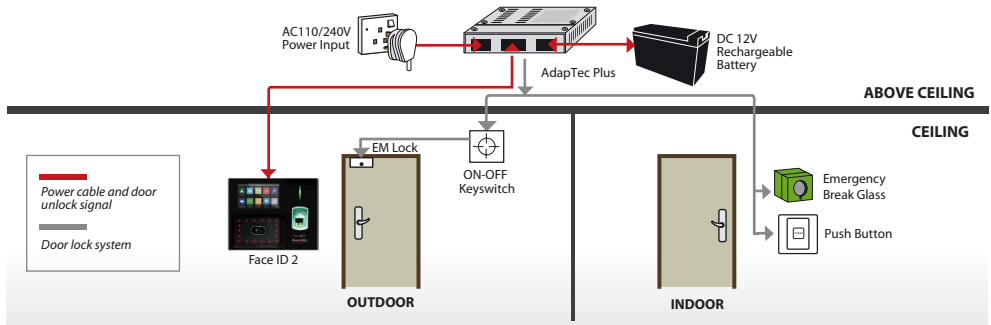

SPECIFICATIONS

MODEL	Face ID 2
SURFACE FINISHING	Acrylonitrile butadiene styrene (ABS) & acrylic
TYPE OF SCANNER	Hi-res infrared camera & fingerprint scanner
MICROPROCESSOR	1.2GHz
MEMORY	128MB Nand flash & 64MB Nand flash
ALGORITHM	Face BioBridge VX8.0, Fingerprint BioBridge VX9.0 / 10.0
PUSH TECHNOLOGY	Yes
DIMENSION (L X W X H), mm	194 x 110 x 145
STORAGE	
Fingerprint templates	10000
Face templates	1200
Transactions	200000
ENROLLMENT & VERIFICATION	
Methods	Face (1:1, 1:N), fingerprint (1:1, 1:N) & password
Recommended fingerprint per user ID	2
Fingerprint placement	Any angle
Verification time (sec)	Face < 2, Fingerprint < 1
Fingerprint	FAR < 0.0001%, FRR < 0.1%
Face	FAR < 0.01%, FRR < 0.1%
COMMUNICATIONS	
Method	TCP/IP, RS232, RS485, USB disk (Optional WiFi & 3G)
Baud rates	9600, 19200, 38400, 57600, 115200
Wiegand	26-bit output
OPERATING ENVIRONMENT	
Temperature (°C)	0 ~ 45
Humidity (%)	20 ~ 80
Power input	DC 12V 3A
TIME ATTENDANCE	
Siren	Internal and external
Work codes	Yes
Fast transaction checking	Yes
MULTIMEDIA	
Display	4.3" 65K color TFT touch screen panel
Photo-ID	Yes
Short messaging	Yes
Day light saving timer	Yes
Internal backup battery	Yes (DC 12V, 2000mAh)
ACCESS CONTROL	
EM lock driving output	DC 12V / relay output
Alarm output	NO/NC
VOICE / DISPLAY LANGUAGE (TERMINAL)	English (Standard), Arabic, Indonesian, Chinese Traditional / Simplified, Cantonese, Vietnamese, Spanish, Portuguese (Portugal), Turkish, Persian. Other languages are available upon request.

NOTE: Specifications are subject to change. Check <http://product.fingertec.com> for latest product information.



Packaging

Dimension (mm) : 298 (L) x 123 (W) x 222 (H)
 Weight : 1.84 kg

Authorized Reseller:



timeTec
www.timeteccloud.com
 TimeTec © 2021, All Rights Reserved