

# FINGERTEC

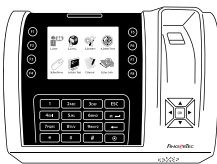

R3



Q2i

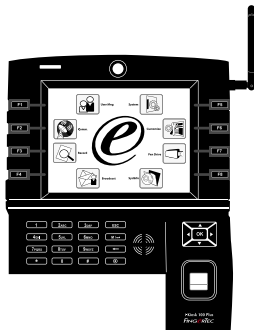

i-Kiosk 100 Plus

## Quick Start Guide

# Terminal Overview

ENGLISH

## • R3

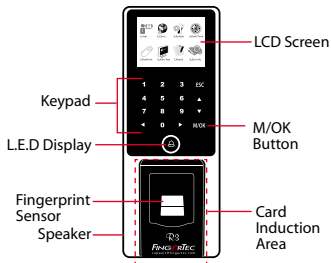

## • Q2i

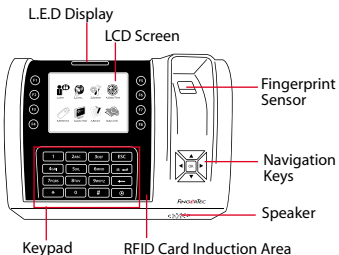

## • i-Kiosk 100 Plus

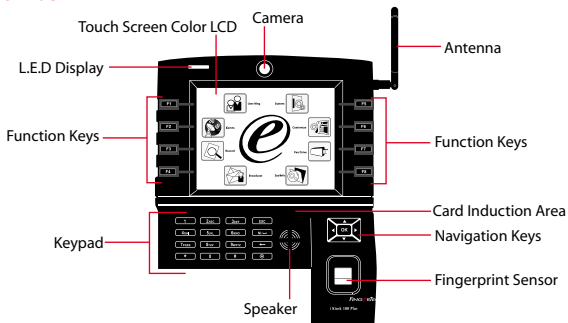

# Quick Start Guide

The Quick Start Guide is intended to provide the user with simple instructions on how to setup the terminal date/time and communication as well as to perform fingerprint and card enrollment and verification. For more details on other topics of terminal management, refer to the terminal's hardware user manual available in the package or online at

- **R3:** <http://info.fingertec.com/r3-4>
- **Q2i:** <http://info.fingertec.com/q2i-4>
- **i-Kiosk 100 Plus:**  
<http://info.fingertec.com/ikiosk100p-4>

## 1 Setting the Date and Time

1. Press **Menu**, select **Date/Time** under Systems.
2. Insert the current date and time and press **OK** to save.

## 2 Enrolling Fingerprints

1. Press **Menu**, go to **User Manage** and select **New User**.

2. Key in a **User ID**, select **Enroll FP** and place the finger on the scanner 3 times according to the instructions.
3. Press **OK** to save then press **ESC**. Press **OK** again, and then **ESC** again to return to the main screen.

## 3 Enrolling Cards

1. Press **Menu**, go to **User Manage** and select **New User**.
2. Key in a **User ID**, select **Enroll Card**.
3. Wave the card until the **Card ID** is displayed on screen. Press **OK** to save and **ESC** to return to the main screen.

## 4 Communication Settings

Press **Menu** > **COMM** > **Network** > Set value for IP/Subnet mask/Gateway > **OK (Save)** > **Security** > **Device ID** > **Set 1** > **OK (Save)** > **ESC** to return to main screen > **Restart** to apply changes.

### Default set value:

IP address - 192.168.1.201  
Subnet mask - 255.255.255.0  
Gateway - 192.168.1.1  
Dev ID - 1  
Password - 0

# Software Roadmap



1

## Installation

The FingerTec Ingress software installer is available in a DVD that comes with all FingerTec terminals. Complete the installation.

2

## Online Activation

Use the terminal's serial number to activate your software online. Contact your local reseller or [support@fingertec.com](mailto:support@fingertec.com) if you require offline software activation.

## 3 System Overview

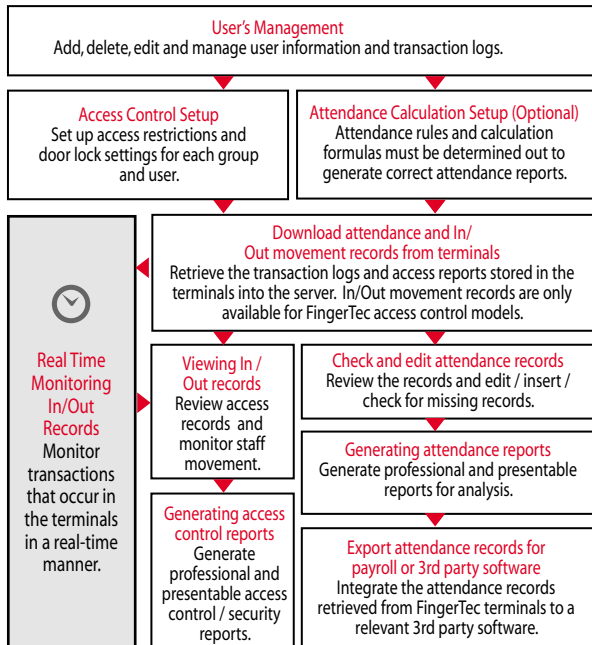

*All complete hardware and software user guides are available in the FingerTec DVD and downloadable online at <http://user.fingertec.com>*

© 2016 Timetec Computing Sdn Bhd. All rights reserved • 052016