



Enhanced Security with
AD@PTEC-X

AdapTec-X is a basic accessory suggested for FingerTec access control systems. It enhances access control functionalities as well as eases the installation process with its encrypted communication and secure I/O expansion features and all these features are compressed into a sleek casing to deliver a cost effective solution.



Enhanced Security with Encrypted Signals*

It supports FingerTec encrypted 26-bit Wiegand communication output; providing enhanced security level for extra protection.



Power Up Terminals & Door Lock Systems

A single AdapTec-X can support a maximum of 2 units of FingerTec terminals and 2 sets of door lock accessories such as the EM Lock and drop bolt in one single system installation.



Prolonged Life Span of Hardware

With data encryption, the life span of the terminals can be prolonged without the risk of short circuiting when using AdapTec-X.



Control IN/OUT Terminals At An Entrance

AdapTec-X is a perfect choice for an IN/OUT installation, where a door is controlled both at the entrance and the exit.



Power Supply and Battery

AdapTec-X connects to a 12VDC switching power supply as power input to operate, and a 12VDC rechargeable backup battery to provide power to ensure protection of access during any events of power failure.



Alert Emergency with Siren

Compatible with an NC siren type with a maximum of 0.5A load for emergency event. E.g. if the terminal is being illegally dismantled.



Seamless Integration with FingerTec Terminals

Mix and match the FingerTec terminals via AdapTec-X for a cost effective access control system suitable for small and medium sized offices.



DIY Metal Casing for Cleaner Installation

Store AdapTec-X, with its power supply and a backup battery in an exclusive FingerTec DIY metal casing, providing a cleaner installation.

WEB LINK

 **Installation Guide**
<http://info.fingertec.com/adaptec-x-1>

 **Video Guide**
<http://info.fingertec.com/adaptec-x-2>

LAYOUT PLAN

Installation Diagram

for illustration only

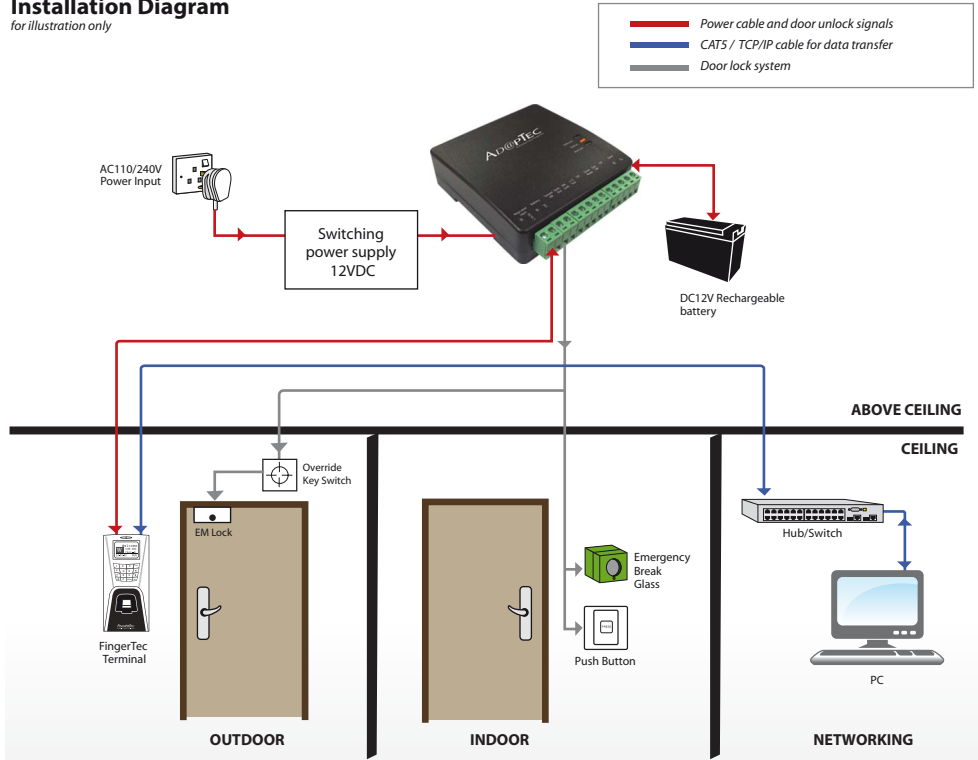

*How AdapTec-X Enhances Security

To provide you enhanced security, AdapTec-X will only recognize encrypted Wiegand signals from FingerTec terminals in order to unlock its doors. The code of the encrypted signals is written into the firmware of FingerTec terminals, which cannot be duplicated into other devices. This prevents hackers from bypassing this by simply providing the relay signal to AdapTec-X. Furthermore, separate power outputs for the door lock system and FingerTec terminals will keep the door locked even during any failures (i.e.: vandalism to terminals, etc.). For added security, a siren output port is ready to be linked up to alarms or sirens to produce alert sounds in case of forced door openings.

SPECIFICATIONS

PHYSICAL APPEARANCE

Surface finishing	Acrylonitrile Butadiene Styrene (ABS)
Dimension, mm	85 x 96 x 33
Weight, kg	0.1
CPU	High Performance RISC CPU

POWER SUPPLY

Power input	12VDC 3A
Power output	12VDC 3A
Backup Power system	UPS or 12VDC Rechargeable battery

INPUT - OUTPUT SIGNAL

Input signal	26-bit FingerTec encrypted Wiegand signal
Output signal	12VDC 0.5A Siren 12VDC 3A EM output (NO/NC Type door locks)

ALERTS & NOTIFICATIONS

Over input voltage	Yes, 3 long beeps
Door release	Yes, 2 short beeps
Door forced open	Yes, continuous beeps (May opt to output external siren system)
Illegal dismantling of FingerTec terminals	Yes, continuous beeps (May opt to output external siren system)
Door unlock timer	VR type, LED blinks to indicate unlock time in Seconds
On Board LED indicators	EM LED lit up - Door lock output is working Status LED lit up - CPU is working Battery low LED lit up - Battery is low and cut-off

ON-BOARD PROTECTION

Over voltage alarm	> 15 VDC
Fuses	PTC type
Battery cut-off	8.5 ~ 9.5 VDC

NOTE: Specifications are subject to change. Check <http://product.fingertec.com> for latest product information.



Packaging

Dimension (mm) : 173 (L) x 60 (W) x 135 (H)
 Weight : 0.3 kg

Authorized Reseller:



timeTec
www.timeteccloud.com

TimeTec © 2021, All Rights Reserved