

Access from a Distance with **The Remote Control Door Switch**

The remote control door switch is a wireless option to link up with an access control system. It is recommended to install it on the ceiling or together with a door controller. In the event of a system failure, the administrator can unlock the door remotely either from inside or outside the premises. Besides that, for an office environment, the Remote Control Door Switch is a useful accessory for receptionists to allow visitors to come and go without manually having to unlock the door.



INSTALLATION DIAGRAM

**for illustration purposes only*

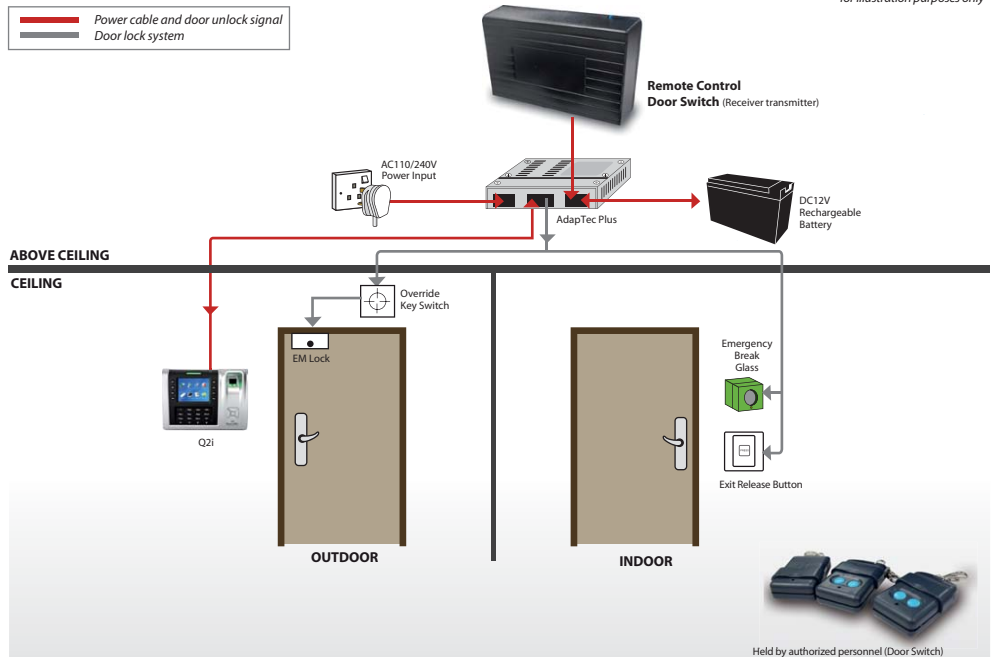

SPECIFICATIONS

DIMENSION (mm)	56 x 33 x 14 (remote control)
	115 x 80 x 30 (receiver)
OPERATING VOLTAGE	12VDC 0.3A
FREQUENCY RANGE (kHz)	329 ~ 331
SENSING RANGE	5 meters

FEATURES & BENEFITS

- Comes with 3 sets of remote control
- Wireless technology
- Small size for easy installation

