



## Emergency Escape with Exit Break Glass



The Exit Break Glass is designed for use in fire detection systems with a central control monitor. It can be used for open or closed circuits and when the glass is pressed hard or broken, the circuit cuts off instantly.

If your fire door requires a key, it's hard to beat a traditional break glass key box for an instantly recognizable means of escape. The soft glass is designed for easy breaking using a hand or fingers to apply pressure on the panel. The doors will remain open after the glass is broken. It provides a quick method of escape or evacuation that still maintains your security.

### Benefits

- The micro switch is used to ensure flawless function of the circuitry.
- The Exit Break Glass comes with double terminal wire connectors for independent input and output connectors. This will facilitate installations when used in looping.
- A test key is provided for instant test operation.

### Specification

Dimension (mm)	51 x 87 x 87
Current rating	12/24VDC, 10A 48VDC, 3A
Net weight	145gm
Color available	Green
Connection	Terminal - Max 2.0mm cable

### Layout Plan

Installation Diagram

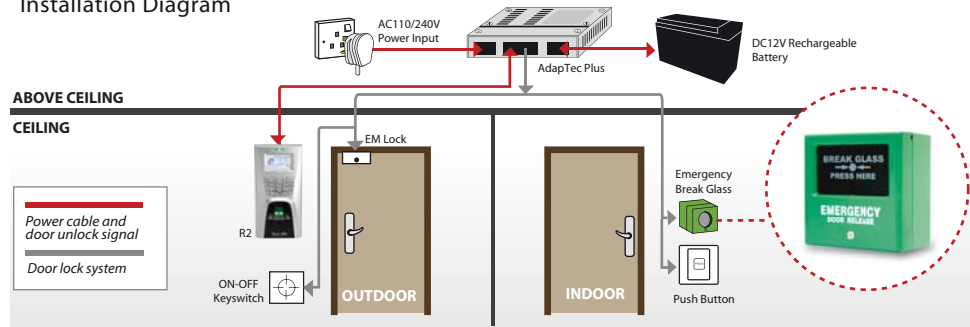

### Anatomy Diagram

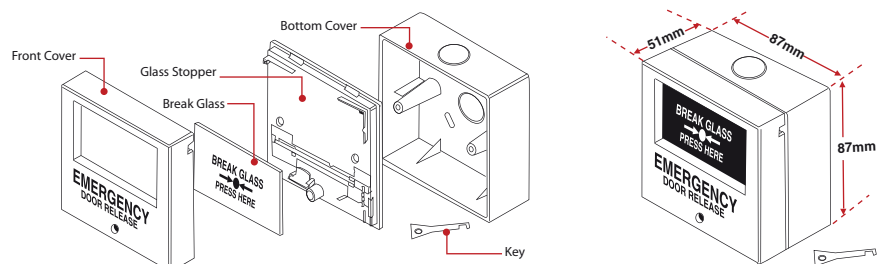

**1** YEAR  
LIMITED WARRANTY  
15 Months  
for Resellers



Like

