



Face ID 3

Face ID 4d

The Quick Start Guide is intended to provide the user with simple instructions on how to setup the terminal date/time and communication as well as to perform face enrollment and verification. For more details on other topics of terminal management, refer to the terminal's hardware user manual available in the package or online at

- **Face ID 3:** <http://info.fingertec.com/faceid3-4>
- **Face ID 4d:** <http://info.fingertec.com/faceid4d-2>

Quick Start Guide

© 2015 Timetec Computing Sdn Bhd. All rights reserved • 012015

1 Setting the Date and Time

- 1 Press **Menu**, select **Date/Time** and set the value.
- 2 You have two options for time format, 12-hour format or 24-hour format.

2 Enrolling Face

Refer to hardware user manual

- 1 Press **Menu** and select **User**.
- 2 Enter your **User ID** and select **Face**.
- 3 Follow the instructions and align your eye position to the green rectangle on the screen to enroll your face.
- 4 Once the enrollment process is done, select the suitable **Privilege** level, and press **Save**.

3 Communication Settings

To input the IP address:

Press **Menu** > **Connection** > **IP Addr** > **Key** in IP address.

To input Subnet mask:

Press **Menu** > **Connection** > **Connection** > **NetMask** > **Insert** the numbers.

To input Gateway:

Press **Menu** > **Connection** > **Connection** > **Gateway** > **Insert** the numbers.

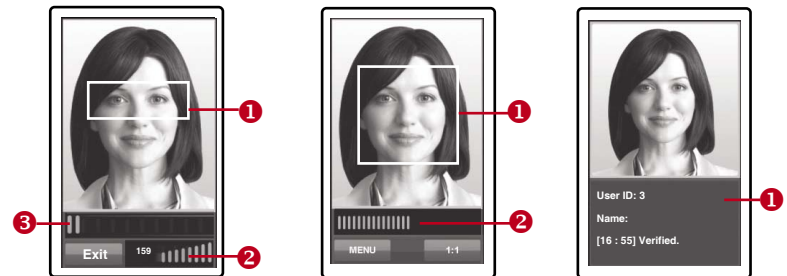

FACE ENROLLMENT

- 1 Align your eye position to appear in this area.
- 2 Status bar to indicate the quality of the captured image; the higher the number, the better the image.
- 3 Progress bar to indicate progress of face enrollment.

VERIFICATION MODE

- 1 Adjust your position so your face appears in this area.
- 2 Status bar to indicate the quality of the captured image; the higher the number, the better the image.

SUCCESSFUL VERIFICATION MODE

- 1 The system will display your photo, user ID and name after verifying your identity.

Terminal Overview • Face ID 3

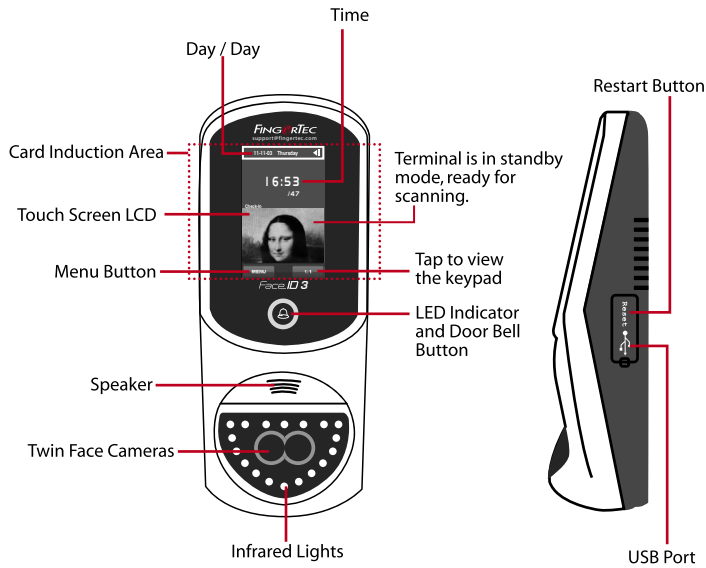

Terminal Overview • Face ID 4d

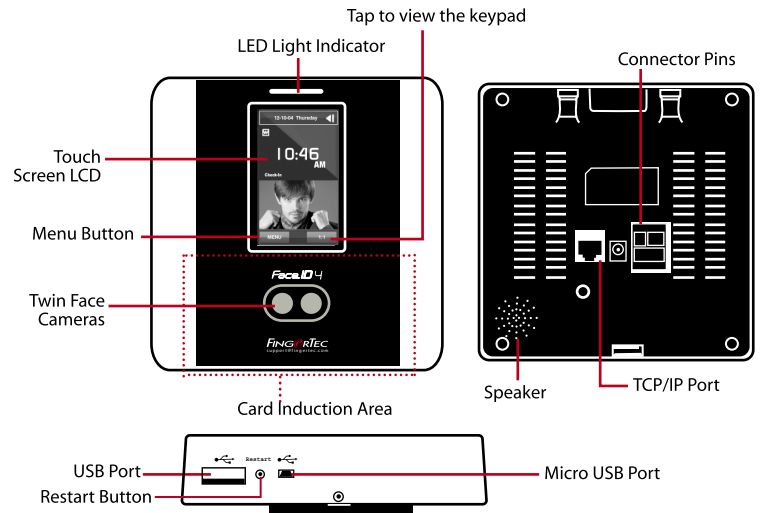

Software Roadmap

1

ingress
Advanced Access Control System

Installation

The FingerTec Ingress software installer is available in a DVD that comes with all FingerTec terminals. Complete the installation.

2



Online Activation

Use the terminal's serial number to activate your software online. Contact your local reseller or support@fingertec.com if you require offline software activation.

3

Real Time Monitoring In/Out Records
Monitor transactions that occur in the terminals in a real-time manner.

System Overview

